

FastSlab Ground Floor Renovation System: Installation Guide.



The steel beams are easy to cut on site:



The beams can site on either a sleeper wall or a steel angle:

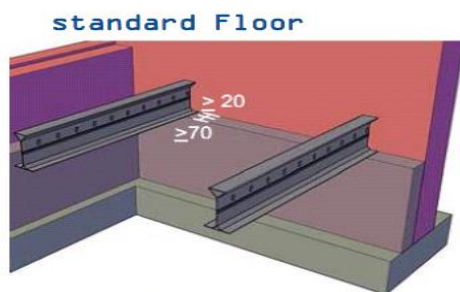

On a brick wall

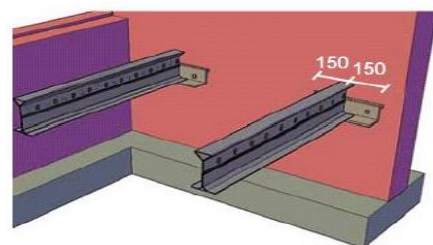

Lay Shoes

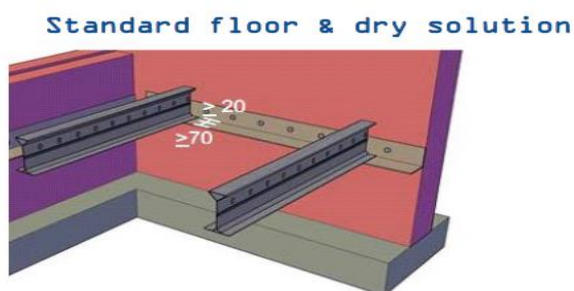

On steel angles

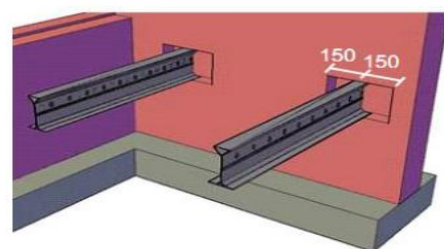

Key elements of FastSlab:

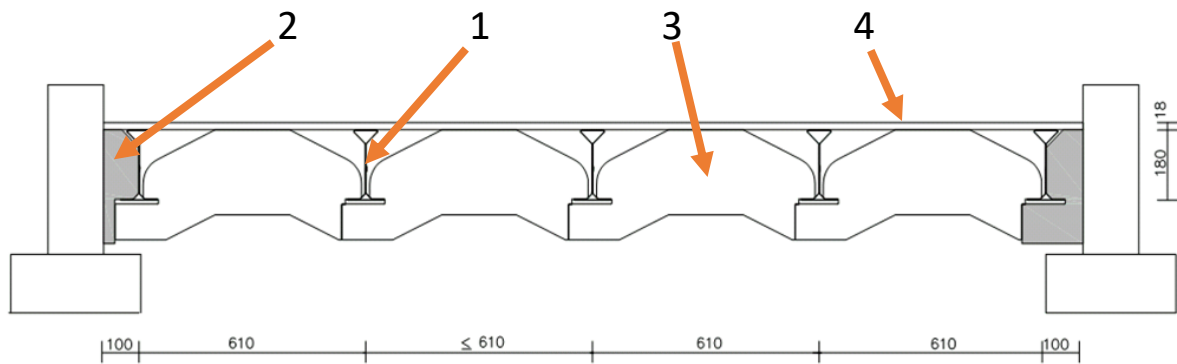

1. FS Steel beam
2. Insulation end piece
3. Full Insulation blocks
4. Lewis Deck

Basic Installation Steps:

1. Construct element for beams to sit on. This can be either a steel angle or a sleeper wall:



2. Set first beam against a wall and trap insulation end piece against the wall to stop cold bridging:



3. Install next beam using the insulation blocks as guide to keep the centres correct:



4. Continue all the way down:



5. You will probably need to cut the insulation in both directions due to the size of the room:



6. Once all of the insulation has been laid then you are ready to install the Lewis Deck on top. Please follow the Lewis Deck Installation guide for this element of work.